

The proDERM Units at the HQ in Schenefeld/Hamburg

- The headquarter of proDERM consists of four units (Management, Luna, Solaris, Sirius)
- In-vivo studies are conducted in the entities Luna and Solaris
- Biophysical measurements and in vitro studies are conducted in Sirius
- All units are located on the second level of a shopping mall
- The mall is being visited by 20,000 visitors a day on average

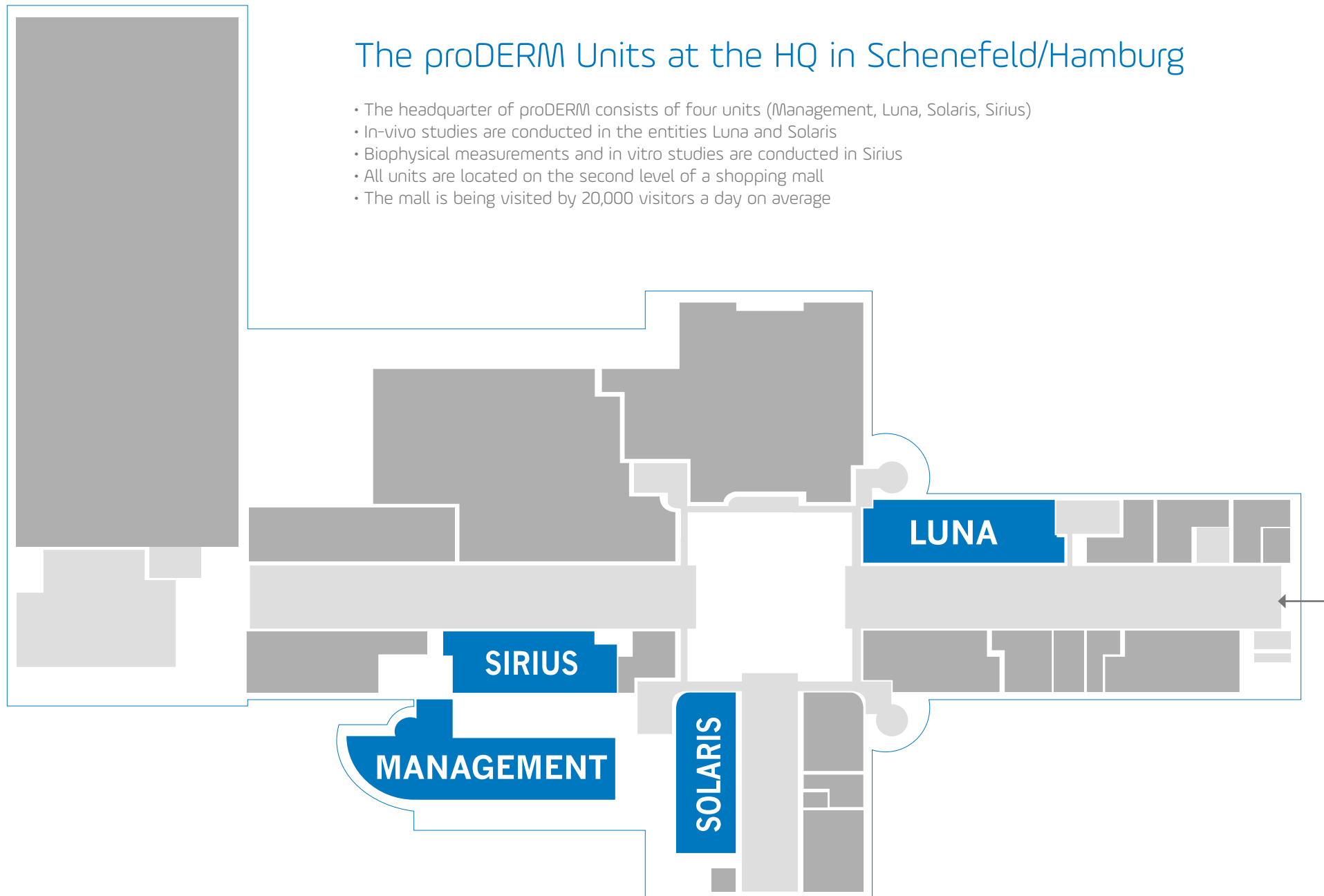

Floorplan proDERM Solaris

- AP/Deo Testing Facilities including Hotroom, Sauna, Changing Rooms
- SPF Testing Facilities including Multiport Room and Whirlpool
- Reception and two Waiting Areas
- 7 Multi-Purpose Examination Rooms

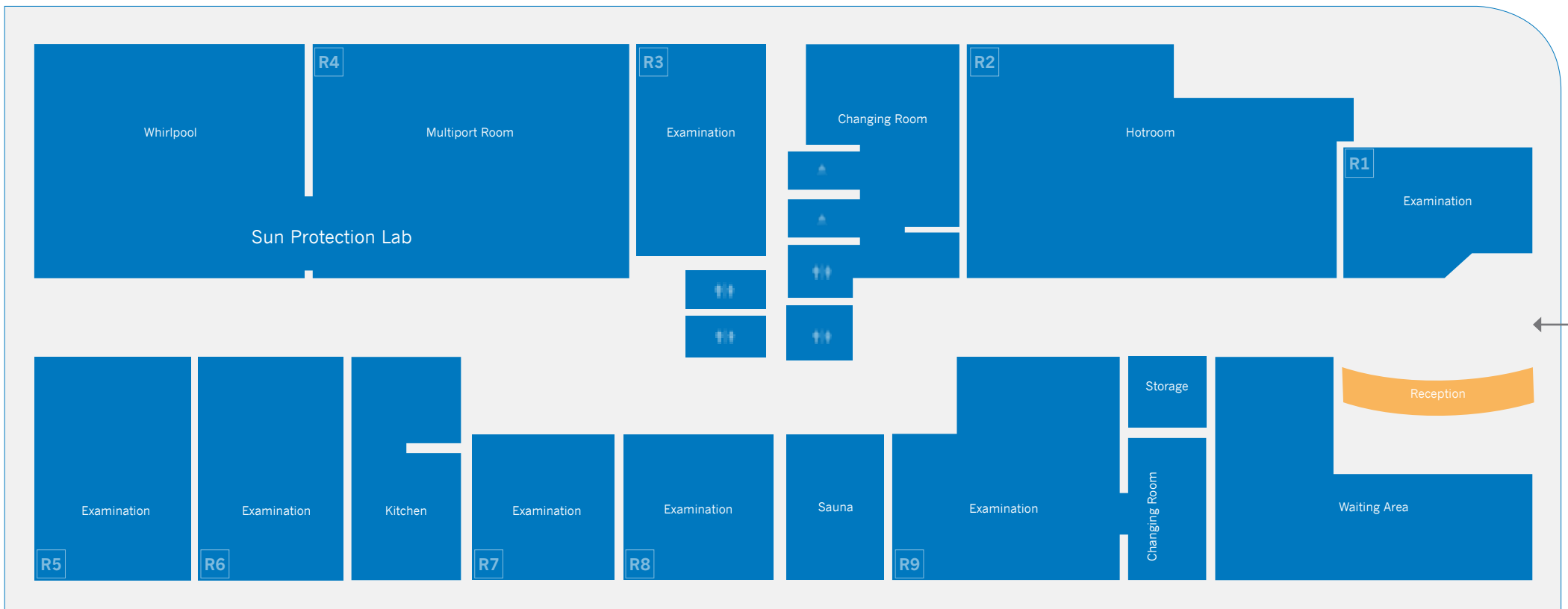
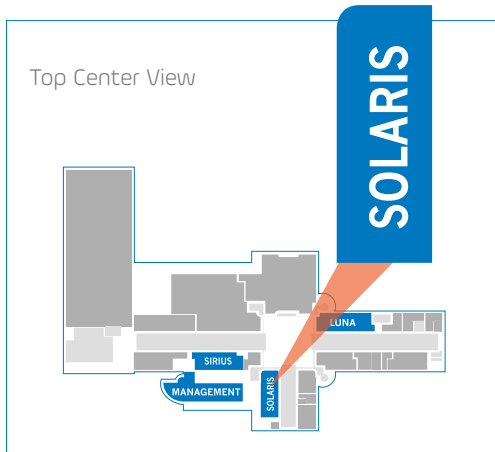

Floorplan proDERM Sirius

- Hair Care Laboratory
- Test Sample Facilities including options for quarantine as well as separation of cosmetic and drug test samples
- Test Sample Preparation Room, In vitro SPF Determination Room
- Offices for Study Technicians and Recruitment

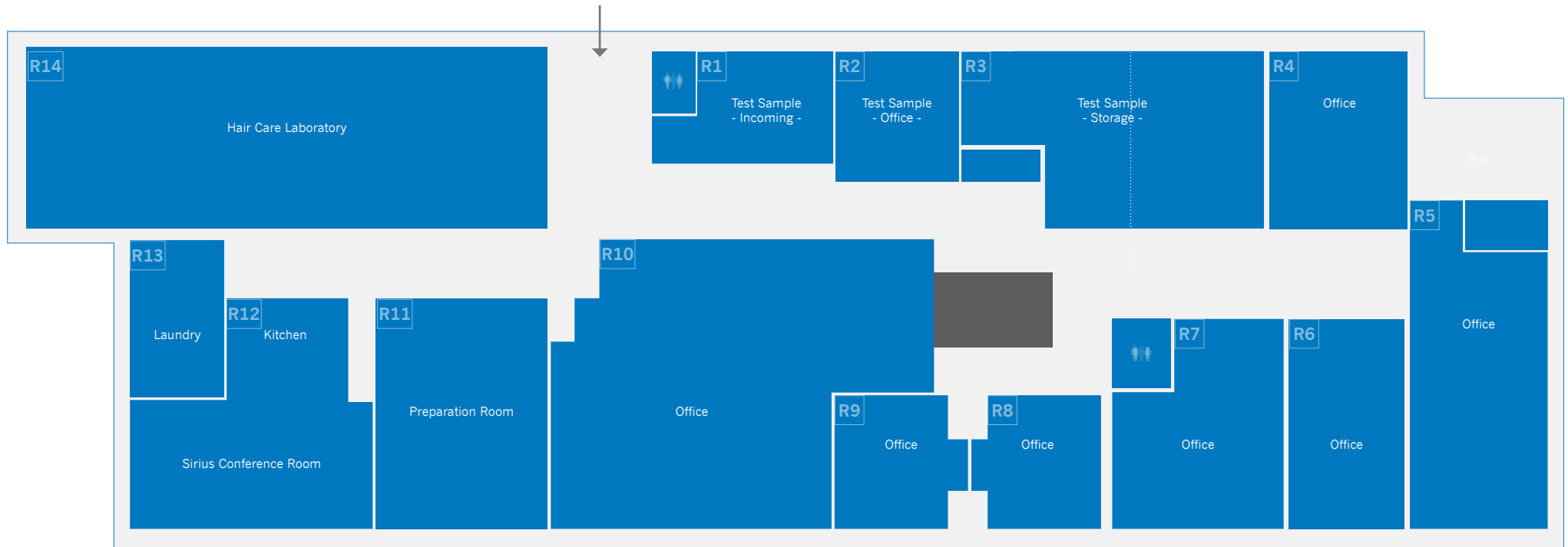
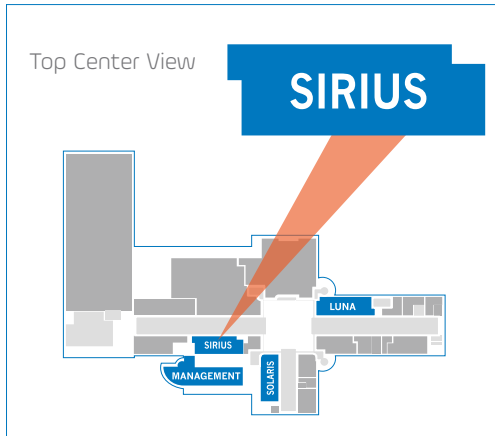

Floorplan proDERM Luna

- 10 Subject Examination Rooms
- Clinical Image Laboratory
- Several Storage Rooms
- Offices
- Subject Reception Area

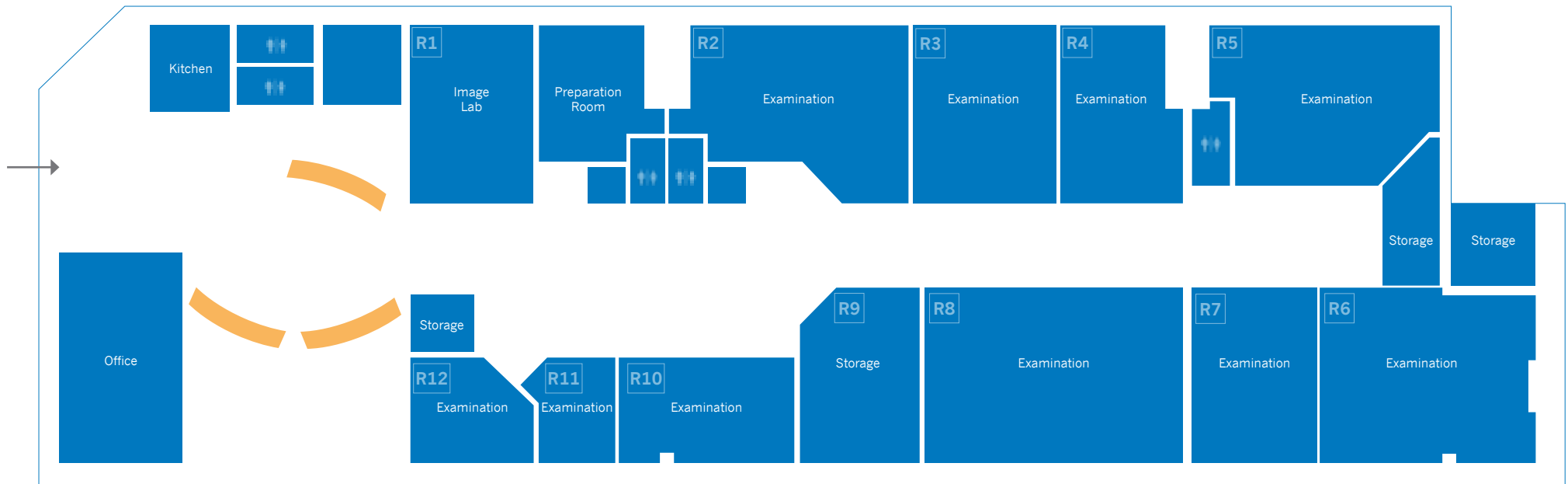
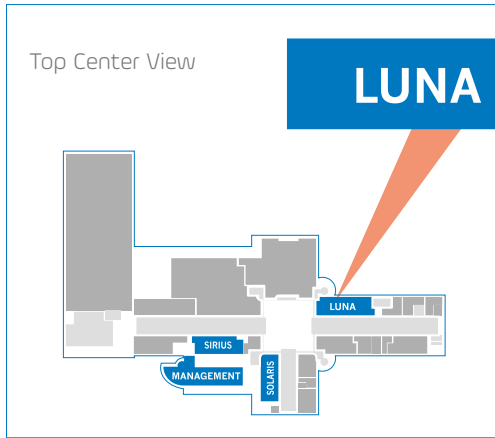

MANAGEMENT

Floorplan proDERM Management

- 22 Office Rooms
- 2 Conference Rooms
- Server Room, IT Storage, Copy Rooms, Library

Top Center View

